

# SHIMANO®

## 1987 REPAIR MANUAL

Shimano American Corporation, One Shimano Dr.  
Irvine, CA 92718

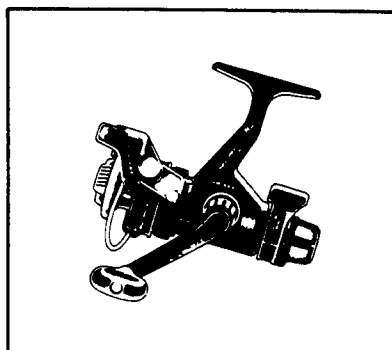

**TO ORDER:**  
This reel belongs to the "Rear Drag" series.  
Please order parts using the abbreviation  
"RD" and the part number.

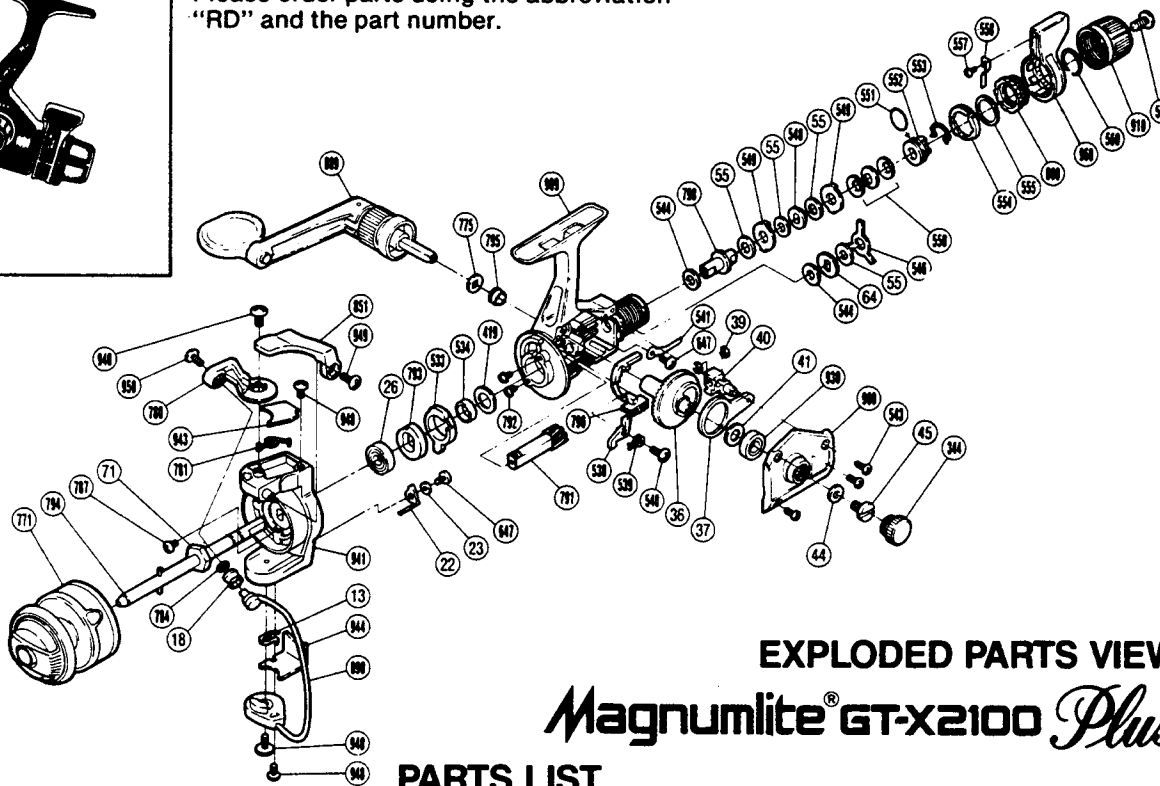

**EXPLODED PARTS VIEW**

**Magnumlite® GT-X2100 Plus**

### PARTS LIST

**PART # DESCRIPTION**

- 13. Lever Spring
- 18. Line Roller
- 22. Bail Trip Lever
- 23. Trip Lever Spacer
- 26. Ball Bearing
- 36. Drive Gear
- 37. Oscillating Arm
- 39. "C" Lock
- 40. Oscillating Block
- 41. Drive Gear Washer
- 44. Handle Lock Washer
- 45. Handle Lock Screw  
(Originally 796)
- 55. Drag Washer "C,"
- 64. Click Gear
- 71. Rotor Nut
- 344. Handle Screw Cap
- 419. Bushing Washer
- 533. Anti-Reverse Lock Out
- 534. Pinion Spacer
- 538. Anti-Reverse Pawl
- 539. Anti-Reverse Pawl Spring
- 540. Anti-Reverse Pawl Screw
- 541. Drag Click

**PART # DESCRIPTION**

- 543. Side Cover Screw
- 544. Drag Washer "C<sub>2</sub>"
- 546. Eared Washer "B<sub>F</sub>"
- 548. Key Washer "A"
- 549. Eared Washer "B"
- 550. Coned Disk Springs
- 551. "O" Ring
- 552. Pressure Screw
- 553. Hold Click Spring
- 554. Lever Click Gear
- 555. Fightin' Pressure Screw  
Washer
- 557. Fightin' Drag Click Screw
- 558. Fightin' Drag Click
- 560. Lever Hold Spring
- 562. Drag Programmer Screw
- 647. Trip Lever Screw
- 771. Spool Assembly(Universal)
- 775. Handle Lock Spacer
- 780. Bail Arm
- 781. Bail Spring
- 784. Line Roller Washer
- 787. Nut Lock Screw

**PART # DESCRIPTION**

- 790. Anti-Reverse Switch
- 791. Pinion Gear
- 792. Multi Purpose Screw
- 793. Anti-Reverse Ratchet
- 794. Main Shaft
- 795. Bushing
- 798. Drag Shaft
- 800. Fightin' Pressure Screw
- 851. Quick-Fire II Trigger
- 889. Handle Assembly
- 890. Bail Assembly
- 900. Side Cover
- 909. Body
- 910. Drag Programmer
- 930. Ball Bearing
- 940. Bail Trip Cam Screw
- 941. Rotor
- 943. Bail Spring Cover
- 944. Bail Trip Cover
- 948. Bail Trip Cover Screw
- 949. Trigger Screw
- 950. Line Roller Screw
- 960. Fightin' Drag Lever